



## MODEL 2266

### Pneumatic Control Valve



The Model 2266 is an inexpensive globe-style control valve for plant utility and process applications. It incorporates linear control characteristic for smooth throttling action on pressure, temperature and liquid level control. The TFE seat provides reliable shut-off for on-off applications. Sizes are 1/2", 3/4", 1", 1-1/2" and 2" (DN15, 20, 25, 40 and 50).

### FEATURES

- Quick change trim
- Linear or quick opening flow characteristics
- Metal seat or TFE soft seat
- Standard internal live-loaded V-ring packing.
- Stainless steel trim
- Full size or reduced orifice trim
- Field reversible fail safe action

### APPLICATIONS

The Model 2266 is capable of handling air, gases, water, steam and cryogenic fluids.

## GENERAL SPECIFICATIONS

**Sizes:** 1/2", 3/4", 1", 1-1/2" and 2"  
(DN15, 20, 25, 40 and 50).

**Body Rating:** 250#ANSIB16.15 for bronze bodies.

**End Connections:** NPT female pipe thread.

**Maximum Inlet Pressures:** Up to 400 psig (27.6 Barg). See Table 5.

**Pressure Drop:** Metal & soft seat, up to 400 psid (27.6 Bard). See Table 1.

**Working Temperatures:** Standard: -20 to +400°F (-29 to +204°C).  
Option-5: -325 to +150°F (-198 to +66°C).  
See Table 5.

**Seat Leakage:** Meets ANSI/FCI 70-2, Class II with metal seat. Class VI with TFE soft seat.

**Rangeability:** 50:1

**Inherent Flow Characteristic:** Linear. The flow characteristic of the trim is produced by the machined contour of the seat ring, rather than the plug. See Opt-90 for Quick Opening.

**Flow Coefficients:** See Tables 2 and 3.

### Bench Set/Instrument Pressures:

Nominal "SIG"		Action	Bench Set psig (Barg)		"Air Supply" psig (Barg)	
psig	(Barg)		psig	(Barg)	psig	(Barg)
3-15	(.21-1.0)	ATO-FC	5-15	(.34-1.0)	20	(1.4)
		ATC-FO	3-13	(.21-.90)		
3-15	(.21-1.0) with P/P Posit.	ATO-FC	5-15	(.34-1.0)	20	(1.4)
			10-30	(.69-2.1)	35	(2.4)
		ATC-FO	3-13	(.21-.90)	20	(1.4)
			6-26	(.41-1.8)	35	(2.4)
6-30	(.41-2.1)	ATO-FC	10-30	(.69-2.1)	35	(2.4)
		ATC-FO	6-26	(.41-1.8)		

**Fail Safe Action:** The valves are easily converted from fail close to fail open.

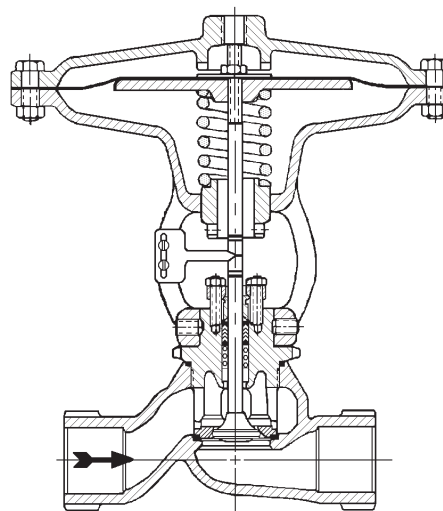

**FIGURE 1**  
1-1/2" (DN40) Model 2266 —  
Metal Seat, Fail Close Action

## BODY SUB-ASSEMBLY SPECIFICATIONS

**Material:** Body - Bronze – ASTM B62  
Bonnet - 1/2"-1-1/2 sizes ASTM B62  
Bonnet - 2" size ASTM B61

**Trims:** Standard construction uses trim S2 or S4. See Table 4 for materials. The TFE soft seat includes metal to metal contact to prevent excessive compression of the TFE.

**Stem:** 5/16" (7.9 mm) diameter on 1/2"-1" (DN15 – 20) valves. 3/8" (9.5 mm) diameter on 1-1/2" and 2" (DN 40, 50) valves.

**Cage:** Bronze on 1/2"-1-1/2" (DN15 – 40) body size (integral with bonnet). 316 SST standard on 2" (DN50) body size; brass made from barstock on 2" (DN50) body size with trim MB4 and MB7.

**Guide Bushing:** Phosphor bronze.

**Packing:** Std. internal Live-loaded TFE V-Ring.

**Packing Follower:** Brass.

**Gaskets:** Seat ring – Fluorogold (TFE derivative) is standard.  
Bonnet – TFE O-ring is standard.

**Bonnet Bolting:** Screwed bonnet, no bolts, on 1/2" – 1-1/2" (DN15-40) valves. GR. B7 studs and Gr. 2H nuts standard on 2" (DN50) valves.

**Packing Flange Bolting:** Type 18-8 SST studs and nuts.

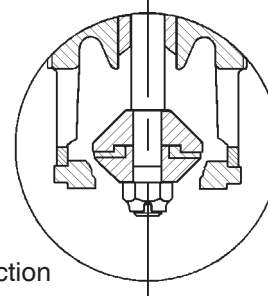

**FIGURE 2**  
TFE Seating — Fail Open Action

## ACTUATOR SUB-ASSEMBLY SPECIFICATIONS

<b>Action:</b>	Increasing loading pressure pushes stem down.	<b>Diaphragm:</b>	Neoprene with nylon insert.
<b>Actuator:</b>	Model 27 used on 3/4", 1" and 1-1/2" (DN20, 25, and 40) valves. Model 50 used on 2" (DN50) valves.	<b>Diaphragm Case and Yoke:</b>	Cast iron (ASTM A126) on 1/2"-1-1/2" (DN 15-40) valves. Cast iron yoke and steel diaphragm cases on 2" (DN50) valves.
<b>Working Temp:</b>	-20 to +180°F (-28 to +83°C.)	<b>Painting:</b>	<u>Standard:</u> All non-corrosion resistant portions to be painted with corrosion resistant epoxy paint per Cashco Spec #S-1606. <u>Alternate:</u> See Opt-95.
<b>Clearance Volume:</b>	12 cu. in. on Model 27 actuator. 28 cu. in. on Model 50 actuator.		
<b>Volumetric Displacement:</b>	9.3 cu. in. on Model 27 actuator. 36 cu. in. on Model 50 actuator.		

## OPTION SPECIFICATIONS

<b>Option-5:</b>	<u>CRYOGENIC CONSTRUCTION.</u> For cryogenic service on oxygen and other fluids. Includes SST column, special TFE bonnet and seat ring gaskets, and Live Loaded TFE packing. Available in TFE seats (S7, MB7) or metal seat (S6). A 5" (127 mm) extension column is used with 1/2" – 1-1/2" (DN15 – 40) valves on gaseous service. A 12" (305 mm) extension column is used on 1/2" – 1" (DN15 – 25) valves on liquid service. A 15" (381 mm) extension column can be used on 1-1/2" (DN25) valves on liquid service; it can also be used on 2" (DN50) valves for <u>both</u> liquid and gaseous service. Cleaned and packaged for oxygen service per Cashco cleaning specification #S-1134. Applicable temperature range -325° to 150°F (-195° to 66°C).	<b>Option -90:</b>	<u>QUICK OPENING CHARACTERISTIC.</u> Alternate trim characteristic. Quick opening is available on 3/4", 1" and 1-1/2" (DN20, 25 and 40) valves. <u>METAL SEAT ONLY.</u> See Table 3 for Cv's.
<b>Option-12:</b>	<u>REDUCED ORIFICE.</u> For reducing the maximum flow rate, or for handling higher pressure drops than the standard orifice will handle. Not available with Option -90, quick opening trim.	<b>Option-95:</b>	<u>EPOXY PAINT.</u> Special epoxy painting of all non-corrosion resistant external surfaces per Cashco Spec #S-1547. Utilized in harsh atmospheric conditions.
<b>Option -15:</b>	<u>STELLITED TRIM.</u> Stellite is applied to 316 SST seat ring and plug, metal to metal seats.		
<b>Option -55:</b>	<u>SPECIAL CLEANING.</u> Cleaned per Cashco Specification #S-1134. With properly selected materials, cleanliness level suitable for oxygen service.		

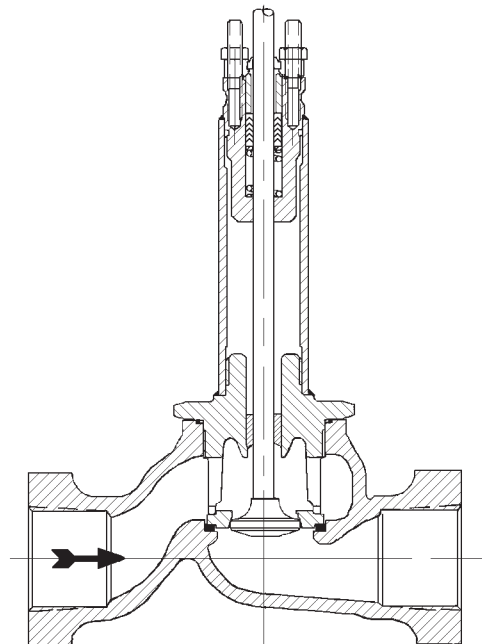

**FIGURE 3**  
1-1/2" Model 2266-5 — Fail Close Action

## ACCESSORY SPECIFICATIONS

**764P or 764PD  
Pressure  
Controller:**

Pressure controller for controlling pressure between vacuum and 2500 psig. The 764PD variation is for differential pressure applications between 1 and 100 psid (.07 and 6.9 Barg). Unit is nipple mounted on the actuator. When a positioner is used, the 764P is bracket mounted.

**Positioner:**

1/2" – 1-1/2" (DN 15–40) VALVES - Top Mounted:  
Moore Products pneumatic positioner, Model 73N12F is top mounted on 1/2"–1-1/2" (DN15–40) valves. 3-15 (.21-1.03 Barg), 3-9 (.21-.62 Barg) or 9-15 (.62-1.03 Barg) psig instrument signal, direct or reverse action.

2" (DN50) VALVES - Yoke Mounted: General. All feedback linkage exposed to elements of SST materials. Aluminum housing with corrosion resistant polyurethane paint. Standard with 2-gauge cluster. Pneumatic output load as required by actuator bench range. Adjustable zero, stroke, gain and damping settings. Field reversible action. Dedicated airset recommended.

P/P Pneumatic. Model 9540L. Accepts 3-15 psig (0.2-1.0 Barg) or 2-way split ranges 3-9 or 9-15 psig (0.2-0.6 or 0.6-1.0 Barg) input signals. Plastic cover with see-through panel to view internal gauges.

I/P Electro-Pneumatic. Model 9520L. Accepts 4-20 mA or 2-way split ranges 4-12 or 12-20 mA input signals. NEMA 3 enclosure, intrinsically safe. FM approved. Gauges mounted on external gauge block.

**Air Tubing:**

Standard instrument air tubing and fittings are Imperial-Eastman "Im-polene" thermoplastic tubing with brass fittings.

**Air Supply  
Regulator:**

Model 5200P is bracket mounted to the diaphragm case. 1/4" (DN8) NPT inlet and outlets. A 1-1/2" (38.1 mm) diameter supply pressure gauge is included.

**Solenoid Valve:**

Standard Brass: Available in standard weatherproof model or explosion-proof model. Brass body, 1/4" (DN8) female NPT connections. Nipple mounted to actuator casing. 120 VAC, 60 Hz power supply.

Gen. Purpose: ASCO #8320G176.

X-Proof: ASCO #EF8320G176.

Alternate SST: Similar to standard brass unit, except with 303 SST body.

Gen. Purpose: ASCO #8320G201.

X-Proof: ASCO #EF8320G201.

Standard installation vents actuator and drives valve to fail-safe position upon loss of electrical power.

**Position  
Indicating  
Switch:**

1/2" – 1-1/2" (DN15–40) VALVES - One or two Proximity probe-type magnetic switches Go Systems "Series 70". Contains one SPDT switch, two amps @ 240 VAC, 50 ma @ 24 VDC.

Standard–Explosion Proof. For "hazardous locations"; Class 1, Division 1, Groups A, B, C and D. (UL listed.)

Valve Action	W/Positioner	WO/Positioner	
	Switch #2-Lower Trip Position *	Switch #1-Upper Trip Position *	Switch #2-Lower Trip Position
ATO-FC	100% Open	Closed	100% Open
ATC-FO	Closed	100% Open	Closed

\* The "upper" switch is NOT available when a top mounted handwheel or P/P positioner is supplied

2" (DN50) VALVES - One or two yoke mounted rotary trip switch(s); contains 1-SPDT switch. Switch rating is 15A @ 125, 250 or 480 VAC. UL rating L96. Up to two switch units may be mounted per valve.

Standard. Microswitch #OP-AR. NEMA 4 enclosure.

Explosion Proof. Microswitch #EX-AR. For "hazardous locations"; NEMA 7, Class 1, Groups C & D; NEMA 9, Class II, Groups E, F and G.

**Top Mounted  
Handwheel  
Assembly:**

Overrides the actuator spring force to stroke the valve. Iron handwheel, stainless steel handwheel screw, bronze bonnet and Buna-N O-ring stem seal. Not available on 1/2" thru 1-1/2" (DN15 thru 40) body sizes when a P/P positioner or an "upper" position indicating switch is supplied.

# TECHNICAL SPECIFICATIONS

**TABLE 1**  
MAXIMUM PRESSURE DROP  
METAL OR TFE SEAT

Valve Size		Model 2266 – Full Port				Model 2266-12 – Reduced Port					
		Orifice Size	Actuator Bench Set				Orifice Size	Actuator Bench Set			
in	(DN)		3-13 psig (Barg) Fail Open	5-15 psig (Barg) Fail Close	6-26 psig (Barg) Fail Open	10-30 psig (Barg) Fail Close		3-13 psig (Barg) Fail Open	5-15 psig (Barg) Fail Close	6-26 psig (Barg) Fail Open	10-30 psig (Barg) Fail Close
1/2" – 1"	(15-25)	3/4"	300 (20.69)	200 (13.79)	400 (27.59)	400 (27.59)	1/2"	400 (27.59)	400 (27.59)	400 (27.59)	400 (27.59)
1-1/2"	(40)	1-3/16"	100 (6.9)	50 (3.45)	150 (10.35)	180 (12.42)	3/4"	300 (20.7)	200 (13.8)	400 (27.59)	400 (27.59)
2"	(50)	1-15/16"	70 (4.83)	40 (2.76)	100 (6.9)	120 (8.28)	1-11/16"	100 (6.9)	50 (3.45)	140 (9.66)	160 (11.04)

**TABLE 2**  
FLOW COEFFICIENTS  
LINEAR CHARACTERISTIC – CV @ 10% TRAVEL INCREMENTS  
METAL OR COMPOSITION SOFT SEAT DESIGN

Flow-to-Open      F<sub>L</sub> Factor = 0.90

Valve Size		Port Size	Orifice Size		Minimum Cont. Cv	Cv at 10% Increments									
in	(DN)		Inch	(mm)		10%	20%	30%	40%	50%	60%	70%	80%	90%	100%
1/2"	(15)	Full	0.750	(19.0)	0.13	0.3	0.9	1.7	2.6	3.5	4.3	5.1	5.9	6.0	<b>6.1</b>
		Opt-12 Red.	0.500	(12.7)	0.07	0.2	0.6	0.9	1.1	1.4	1.8	2.4	2.9	3.2	<b>3.4</b>
3/4"	(20)	Full	0.750	(19.0)	0.16	0.3	1.0	1.8	2.8	3.8	4.9	6.3	7.5	8.1	<b>8.4</b>
		Opt-12 Red.	0.500	(12.7)	0.07	0.2	0.6	0.9	1.1	1.4	1.8	2.4	2.9	3.3	<b>3.5</b>
1"	(25)	Full	0.750	(19.0)	0.19	0.3	1.1	2.0	3.1	4.0	5.3	6.9	8.4	9.2	<b>9.5</b>
		Opt-12 Red.	0.500	(12.7)	0.07	0.2	0.6	0.9	1.1	1.4	1.8	2.5	3.0	3.4	<b>3.6</b>
1-1/2"	(40)	Full	1.187	(30.2)	0.38	0.6	2.1	3.7	5.4	7.6	10.0	12.4	14.8	16.8	<b>19.3</b>
		Opt-12 Red.	0.750	(19.0)	0.19	0.4	1.1	2.0	2.9	3.9	5.4	7.2	8.4	9.2	<b>9.5</b>
2"	(50)	Full	1.937	(49.2)	0.91	2.8	7.2	12.3	19.8	27.7	34.2	38.2	40.4	42.0	<b>45.3</b>
		Opt-12 Red.	1.687	(42.9)	0.62	1.8	4.6	8.0	10.8	13.8	16.0	18.6	21.8	25.9	<b>30.7</b>

METRIC CONVERSION FACTOR: Cv / 1.16 = kv

**TABLE 3**  
FLOW COEFFICIENTS  
QUICK OPENING CHARACTERISTIC – CV @ 10% TRAVEL INCREMENTS  
METAL SEAT DESIGN ONLY

Flow-to-Open      F<sub>L</sub> Factor = 0.90

Valve Size		Port Size	Orifice Size		Minimum Cont. Cv	Cv at 10% Increments									
in	(DN)		Inch	(mm)		10%	20%	30%	40%	50%	60%	70%	80%	90%	100%
3/4"	(20)	Full	0.750	(19.0)	.16	2.1	4.3	5.6	6.2	6.8	7.3	7.8	8.0	8.3	<b>8.4</b>
1"	(25)	Full	0.750	(19.0)	.20	2.4	4.5	5.9	6.9	7.7	8.3	8.8	9.2	9.5	<b>10.0</b>
1-1/2"	(40)	Full	1.187	(30.2)	.40	3.7	6.2	9.9	12.0	14.0	15.7	17.2	18.5	19.7	<b>20.0</b>

METRIC CONVERSION FACTOR: Cv / 1.16 = kv

**TABLE 4**  
TRIM MATERIAL COMBINATIONS

Part	Trim Materials					
	Standard 2266			Cryogenic 2266-5 — with Extension Column		
	S2	S4	MB4	S6	S7	MB7
Plug/Stem	316/316 SST	--	--	316/316 SST	--	--
Seat Ring	303 SST	303 SST	Brass	303 SST	303 SST	Brass
Guide Bushing	Phos. Bronze	Phos. Bronze	Phos. Bronze	Phos. Bronze	Phos. Bronze	Phos. Bronze
Seat Ring Gasket	Fluorogold	Fluorogold	Fluorogold	Fluorogold	Fluorogold	Fluorogold
Bonnet Gasket	TFE	TFE	TFE	Spring Loaded TFE	Spring Loaded TFE	Spring Loaded TFE
Stem	--	316 SST	Monel	--	316 SST	Monel
Adaptors	--	303 SST	Brass	--	303 SST	Brass
Castle Nut	--	18-8 SST	Brass	--	18-8 SST	Brass
Cotter Pin	--	18-8 SST	Brass	--	18-8 SST	Brass
Seat Disc	--	TFE	TFE	--	TFE	TFE

**TABLE 5**  
MAXIMUM INLET PRESSURE

Body Material	Size	Inlet Pressure		Temperature	
		psig	(Barg)	°F	(°C)
Bronze	All	400	(27.5)	-20 to +150	(-28 to +65)
		250	(17.2)	-20 to +400	(-28 to +204)
Bronze, Opt-5 Cryo.	All	400	(27.5)	-325 to +150	(-198 to +65)

**DIMENSIONS AND WEIGHTS**

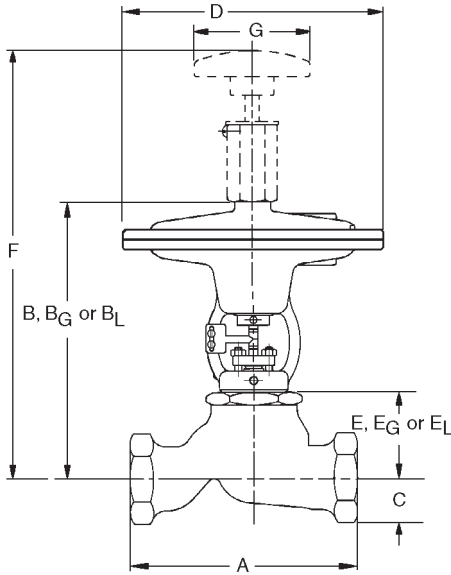

**1/2" – 1-1/2" (DN15 – 40) Size  
with Model 27 Actuator**

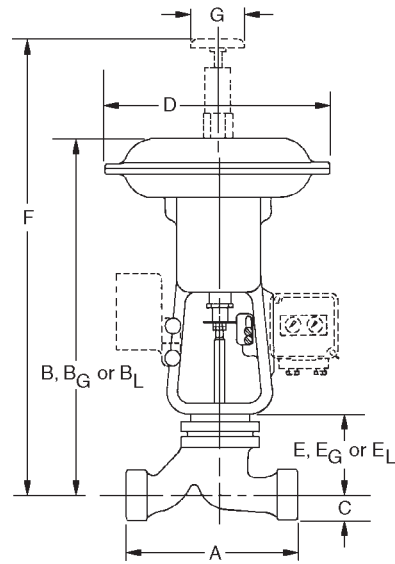

**2" (DN50) Size with Model 50 Actuator**

**English Units – In. & lbs.**

Body Size	Standard							Cryogenic				Weight <sup>1</sup>
	A	B	C	D	E	F	G	Gas Service		Liquid Service		
								B <sub>G</sub>	E <sub>G</sub>	B <sub>L</sub>	E <sub>L</sub>	
1/2" – 1"	4.31	9.06	1.62	9.00	2.25	14.22	4.0	14.00	7.25	21.75	14.25	20 lbs.
1-1/2"	7.88	9.81	1.59	9.00	3.00	14.97	4.0	14.77	7.96	24.77	17.96	25 lbs.
2"	9.38	16.68	1.69	10.50	3.68	24.50	4.0	33.09	20.09	33.09	20.09	42 lbs.

<sup>1</sup> For Opt-5 Cryogenic Construction, add 5 lbs.

**Metric Units – mm & kg**

Body Size	Standard							Cryogenic				Weight <sup>1</sup>
	A	B	C	D	E	F	G	Gas Service		Liquid Service		
								B <sub>G</sub>	E <sub>G</sub>	B <sub>L</sub>	E <sub>L</sub>	
DN15–25	110	230	41	229	57	361	102	336	184	552	362	9 kg.
DN40	200	249	40	229	76	380	102	375	202	629	456	11 kg.
DN50	238	424	43	267	94	622	102	840	510	840	510	19 kg.

<sup>1</sup> For Opt-5 Cryogenic Construction, add 2.3 kgs.

---

## NOTES

# MODEL 2266 PRODUCT CODE 02/12/09

**42**

Table 1 — Table 2 — Table 3 — Table 4 — Table 5 Table 6 Table 7 Table 8 Table 9 Table 10 **0** Table 11 **D**

TABLE 1 - SIZE				
Body (Bronze)				
Size		Std.	Cryo.	
in	(DN)	CODE	CODE	
1/2"	(15)	A	H	
3/4"	(20)	1	J	
1"	(25)	2	R	
1-1/2"	(40)	3	S	
2"	(50)	4	M	

TABLE 2 - TRIM DESIGNATION NUMBER					
Construction	Body Sizes	Opt.	Trim Desig.	CODE	
Standard	All	—	S2	5	
		—	S4	6	
		—	MB4	7	
Standard: Special Clean <sup>1</sup>	All	-55	S2	8	
		-55	S4	9	
		-55	MB4	G	
* Cryogenic with 5" Column for Gas: Special Clean <sup>1</sup>	1/2" - 1-1/2" (DN15-40)	-5	S6	A	
		-5	S7	B	
* Cryogenic with 12" Column for Liquid: Special Clean <sup>1</sup>	1/2" - 1" (DN15-25)	-5	S6	K	
		-5	S7	L	
* Cryogenic with 15" Column for Liquid: Special Clean <sup>1</sup>	1-1/2" (DN40)	-5	S6	M	
		-5	S7	N	
* Cryogenic with 15" Column for Liquid and Gas: Special Clean <sup>1</sup>	2" (DN50)	-5	S6	T	
		-5	S7	U	
* Cryogenic with 15" Column for Liquid and Gas: Special Clean <sup>1</sup>	2" (DN50)	-5	MB7	D	
		-5	MB7	F	

\* Applies only to code selected from "Cryo" column in Table 1 of this coder.  
Cryogenic construction is "non-asbestos"  
<sup>1</sup>Clean to Spec. #S-1134

TABLE 3 - PORT SIZE & CHARACTERISTIC							
Port Size	Character	Options	Seat Designs		Body Sizes	CODE	
			Metal	TFE-Soft		Std. Flow DIR-FTO	Std. Flow DIR-FTC
Full	Linear	—	✓	✓	All	10	—
Full & Stell.	Linear	-15	✓	—	All	1A	—
Red.	Linear	-12	✓	✓	All	20	—
Red. & Stell.	Linear	-12+15	✓	—	All	2A	—
Full (Q.O.)	Quick Opening	-90	✓	—	3/4" to 1-1/2"	80	30

TABLE 4 - PRODUCT CLASSIFICATION Under European "Pressure Equipment Directive"		
PRODUCT	HAZARD CATEGORY	CODE
Standard	N/A	7
EUROPEAN <sup>1</sup> Consult Factory for Special Code (PED does not apply to DN25 and below)	Sound Engineering Practice (SEP)	S
	CE Marked Hazard Cat I or II	E

<sup>1</sup> For products to be placed in service in Europe (See Cashco Spec. # 7E13)

TABLE 5 - ACTUATOR				
Actuator			W/O Handwheel	With Handwheel *
Action	Fail Position	Bench Range (psig)	CODE	CODE
ATO	Close	5-15	5	E
ATO	Close	10-30	6	F
ATC	Open	3-13	7	G
ATC	Open	6-26	8	H

\* Manual Handwheel & Pneumatic Positioner are not available together on same unit on sizes 1/2" thru 1-1/2" (DN15 thru 40). The 2" (DN50) size may utilize both. Consult Tech Bulletin for allowable pressure drop.

TABLE 6 - POSITIONER with AIRSET (Select Airset Range from Table 9)			
No Positioner			CODE
			0
I/P Electro-Pneu. Positioner *	CODE	P/P Pneumatic Positioner ✓	CODE
Direct 4-20 ma	A	Direct 3-15 psig	1
Reverse 20-4 ma	B	Reverse 15-3 psig	2
Direct Split Range 4-12 ma	C	Direct Split Range 3-9 psig	5
Direct Split Range 12-20 ma	D	Direct Split Range 9-15 psig	6
Reverse Split Range 12-4 ma	E	Reverse Split Range 15-9 psig	7
Reverse Split Range 20-12 ma	F	Reverse Split Range 9-3 psig	8

NOTES: (1) Airset supplied w/gauge. Select range in Table 8. (2) On sizes 1/2", 3/4", 1" & 1-1/2", the Moore Positioner is utilized; the 2" size utilizes Models 9520L(I/P) & 9540L(P/P).  
\* I/P Positioner NOT AVAILABLE on 1/2", 3/4", 1" or 1-1/2" sizes.  
✓ P/P positioner supplied, is not available with either manual handwheel or "upper" position limit switch for 1/2" thru 1-1/2" sizes.

TABLE 7 - TUBING	
Tubing	CODE
Special Construction	X
None (No Positioner, Airset, Solenoid, etc.)	0
Std. - Impolene Tubing, Brass Fittings	1
Copper Tubing, Brass Fittings	2
SST Tubing & Fittings	3

When ordering a valve per one of Cashco's special drawings, the code "X" and the 5-digit number following override all other options. Otherwise, proceed with the following tables.

TABLE 8 - POSITION LIMIT SWITCHES						
Applic. Sizes	MFG Model	Type	No. of Switch Units *	Trip Position at "Plug"	W/ATO Actuator	W/ATC Actuator
					CODE	CODE
ALL	NONE	-	0	NONE	0	0
1/2" Thru 1-1/2" (DN15-40)	GO Systems "SERIES 70" 73-13528-A1	General Purpose	1	Full Open	D	G ✓
			1	Closed	E ✓	H
	GO Systems "SERIES 70" 73-13523-A1	Magnetic Proximity X-Proof	2	Closed & Full Open	F ✓	J ✓
			1	Full Open	4	7 ✓
					5 ✓	8
					6 ✓	9 ✓
CODE **						
2" (DN50)	Microswitch #OP-AR	Rotary Trip; NEMA4	1	Closed	1	
			1	Full Open	2	
			2	Closed & Full Open	3	
	Microswitch #EX-AR	Rotary Trip; NEMA7 X-Proof	1	Closed	A	
			1	Full Open	B	
			2	Closed & Full Open	C	

\* Each "switch unit" contains 1-STDP switch. If using positioner on 3/4-1-1/2"(DN20-40) size, 1 switch available either plug closed or full open.  
\*\* Code independent of actuator action  
✓ "Upper" switch not available when supplied w P/Positioner or manual handwheel.

TABLE 9 - AIRSET RANGE (for Airset Table 6)		
For Bench Set (Table 5)	Range	CODE
3-13, 5-15 psig	0-30 psig	A
6-26, 10-30 psig	0-60 psig	B
No Positioner / Airset		0

TABLE 10 - ACCESSORIES	
Accessories	CODE
None (Other than indicated on this coder.)	0
Valve Mtd. Accessories - Any of following 3-Way Solenoid Valve; Bracket Mtded 764P Press.Controller; Extra Airset(s); I/P Transducer; Lockup Valve	9 *

\* Use of a "9" Code requires that a "99" Coder sheet be completed.

TABLE 11 - PAINTING		
Description	Option	CODE
Standard	—	0
Epoxy Painted Per Cashco Spec #S-1547	-95	1

Cashco, Inc.  
P.O. Box 6  
Ellsworth, KS 67439-0006  
PH (785) 472-4461 • FAX (785) 472-3539  
www.cashco.com  
E-mail: sales@cashco.com  
exportsales@cashco.com  
Printed in U.S.A. Model 2266-TB