

MODEL 4400

SPRING LOADED PRESSURE VENT TO ATMOSPHERE

OVERVIEW

The Model 4400 spring loaded pressure relief vents are designed for higher pressure settings and are used in applications for normal or emergency venting pressure relief. The series 4400 vents are pressure only devices and as such do not provide vacuum relief. Vacuum relief must be supplied by the operating vent with which the tank is equipped. If vacuum relief is needed, see Valve Concepts Technical Bulletin 3300, 3600, 4100, or the 4200.



MODEL 4400

SPECIAL FEATURES

- Easy Inspection:** The 4400 series vent is light weight and designed for trouble free entry for inspection and maintenance. A coarse, mesh screen prevents entry of foreign matter into seating area.
- Maintains Accurate Settings:** The minimum pressure setting is 1.25 psig and the maximum setting is 15 psig. As with every vent supplied by Valve Concepts a certified test report is provided verifying vent setting and a leakage rate of no more than 1 SCFH at 90% of the customer specified set point.
- Air-Cushioned Seating:** Air-cushion seating provides tight sealing to reduce the unnecessary release of vapors and loss of product to the atmosphere.

TECHNIQUE

Under normal operating conditions, the spring-loaded pallet assembly is closed providing a vapor-tight seal. In the event the tank pressure reaches the set point of the vent, due to product movement into the tank, thermal expansion of the product and vapors or due to an emergency (fire involvement of the tank), the spring-loaded pallet lifts to vent excess vapors thereby protecting the tank from dangerous over pressurization. Once the over pressure condition is relieved the spring-loaded pallet closes to provide a vapor tight seal.



LINE SIZES AVAILABLE
2" (DN50), 3" (DN80), 4" (DN100),
6" (DN150)



END CONNECTIONS
FLANGED



COMMON APPLICATIONS
DESIGNED FOR HIGHER PRESSURE
SETTINGS FOR NORMAL OR
EMERGENCY VENTING PRESSURE
RELIEF



DESIGN PRESSURE
MULTIPLE SET PRESSURE
RANGES AVAILABLE

CONSTRUCTION

Housing Material: Flange base available in Aluminum, Carbon Steel, or 316 SST. Weatherhood available in Carbon Steel or 316 SST.

MATERIALS OF CONSTRUCTION		
Series	Housing	Pallet
4400CS	CS	316 SST
4400SST	316 SST	316 SST
4400A	Aluminum	316 SST

Sizes - Connections. Available is Sizes 2" through 6". CS and SST vents have Raised Face Flange, Aluminum vents have Flat Face Flange to mate with standard ASME150# flange connections.

Pallet Diaphragm Material: FEP TFE is Standard. Also available Buna-N, EPDM or Fluorocarbon Elastomer (FKM).

STANDARD/GENERAL SPECIFICATIONS

Gaskets: Standard: TFE/TFE Rope

Painting: Standard: Exterior coating will be a combination of Cashco Paint Specs #S-1777 epoxy and #S-1743 powder coated. Fasteners, seat surfaces and corrosion resistant parts excluded.

Diaphragm Temperature Limits:
FEP-TFE:
 -400° to 400° F (-240° to 204°C)
Fluorocarbon Elastomer – (FKM):
 -20° to 400° F (-28° to 204°C)
Buna-N (Nitrile-NBR):
 -30° to 200° F (-34° to 93°C)
EPDM (Ethlenepropylene):
 -40° to 225° F (-40° to 107°C)

DIMENSIONS

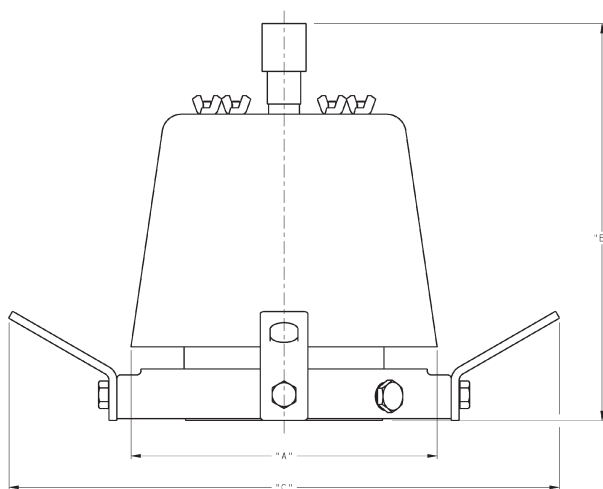

Aluminum, Carbon Steel & Stainless Steel Flange & Carbon Steel & Stainless Steel Weather Hood in. (mm)							Weight lbs. (kg.)	
Size In (DN)	A (diam.)		B		C		Aluminum	CS / SST
2" (50)	7.50"	(191)	9.54"	(242)	N/A	N/A	7 (3)	14 (6)
3" (80)	9.20	(234)	10.56"	(271)	N/A	N/A	11 (5)	22 (10)
4" (100)	9.62"	(244)	12.50"	(317)	17.29	(439)	16 (7)	32 (14)
6" (150)	13.00"	(330)	14.61"	(371)	19.29	(490)	21 (9)	42 (19)

The contents of this publication are presented for informational purposes only, and while every effort has been made to ensure their accuracy, they are not to be construed as warranties or guarantees, express or implied, regarding the products or services described herein or their use or applicability. We reserve the right to modify or improve the designs or specifications of such product at any time without notice. Cashco does not assume responsibility for the selection, use or maintenance of any product. Responsibility for proper selection, use and maintenance of any Cashco product remains solely with the purchaser.

4400 Series PRODUCT CODE

02/07/20

Last 6 Characters reserved for SPQ drawing numbers assigned by Cashco
(Format as - # # # # #)

44 0 POS 4 POS 5 B POS 7 POS 8 0 0 0 0 0 0 0 0 0 0

POSITION 4 - FLANGE - SIZE			
ASME INCH	CODE	DIN FLANGES DN (rating)	CODE
2"	2	50 (PN16)	H
3"	3	80 (PN16)	J
4"	4	100 (PN16)	K
6"	6	150 (PN16)	L

POSITION 5 - BODY / TRIM / WEATHER HOOD MATERIALS	
MATERIAL	W/O Flamescreen
	CODE
ALUM/SST/SST	A
CS/SST/CS	C
SST/SST/SST	S

POSITION 7 - DIAPHRAGM MATERIALS	
DIAPHRAGM	CODE
FEP TFE (Std.)	A
Buna-N	B
EPDM	D
FKM	F

POSITION 8 - PRESSURE SET POINT		
Spring Loaded Range		CODE
psig	barg	
1.25 - 4	.08 - .27	2
> 4 - 6	> .27 - .41	3
> 6 - 8	> .41 - .55	4
> 8 - 10	> .55 - .68	5
> 10 - 12	> .68 - .83	6
> 12 - 13	> .83 - .89	7
> 13 - 15	> .89 - 1.03	8

Cashco
P.O. Box 6
Ellsworth, KS 67439-0006
PH (785) 472-4461
Fax. # (785) 472-3539
www.cashco.com
email: sales@cashco.com
Printed in U.S.A. 4400-TB

Cashco GmbH
Handwerkerstrasse 15
15366 Hoppegarten, Germany
PH +49 3342 30968 0
Fax. No. +49 3342 30968 29
www.cashco.com
email: germany@cashco.com

Cashco do Brasil, Ltda.
Al.Venus, 340
Indaiatuba - Sao Paulo, Brazil
PH +55 11 99677 7177
Fax. No.
www.cashco.com
email: brazil@cashco.com